

Dave Savage
Regional Manager (Dark and White Peak)
Derbyshire Wildlife Trust



Quiz time

How many species of plant and animal are at serious risk of extinction across the world?

The United Nations have reported that around 1 million animal and plant species are now threatened with extinction, many within decades, more than ever before in human history.

We are facing both a climate and an ecological crisis.

Remember this.....?





How many of these creatures will be extinct in a generation?

The Facts

- The average abundance of native species in most major land-based habitats has fallen by at least 20%, mostly since 1900
- More than 40% of amphibian species
- 33% of reef-forming corals
- 33% of all marine mammals are threatened
- 10% of all insect species

Since 1600

- 570 animal species extinct
- 700 plant species extinct



What about us?



Quiz time

Out of 218 countries assessed for
'biodiversity intactness'
where is the UK ranked?

Of the 218 countries assessed for "biodiversity intactness",
the UK is ranked at 189.

We are among the most nature-depleted countries in the
world



What are the main factors in the UK?

State of Nature report produced by wildlife groups on a regular basis monitors wildlife in the UK.

2019 Report - <https://www.rspb.org.uk/our-work/state-of-nature-report/>

13% Decline in average species abundance

41% of species are in decline

15% of species threatened with extinction

27% Decline in areas occupied by priority species

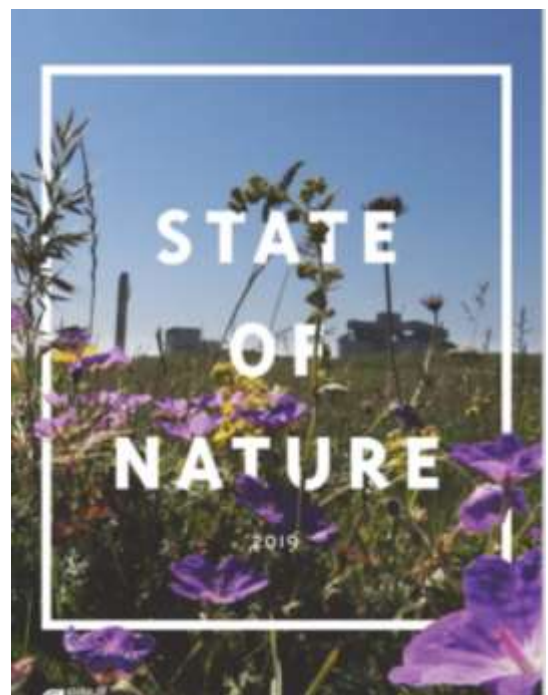

In 2020, Defra published the Lawton Report - 'Making space for nature': a review of England's wildlife sites`

The report makes the following key points for establishing a strong and connected natural environment:

- That we better protect and manage our designated wildlife sites;
- That we establish new Ecological Restoration Zones;
- That we better protect our non-designated wildlife sites.

Lawton recommended that nature recovery networks should be `bigger, better and more connected`.

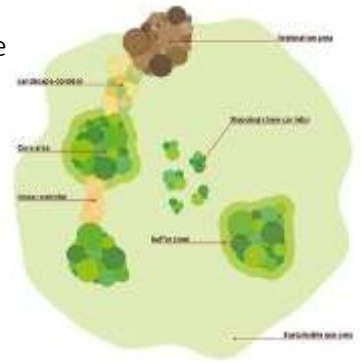

The Wildlife Trusts are calling for at least 30% of our land and sea to be connected and protected for nature's recovery by 2030.





Is this a wildlife rich area?
Beautiful certainly - but maybe a wildlife desert?



What does this mean for area to be improved in
the Peak District (total area - 372,181.3 Hectares)



30% = 111,654 Ha

or 136,163
football pitches!

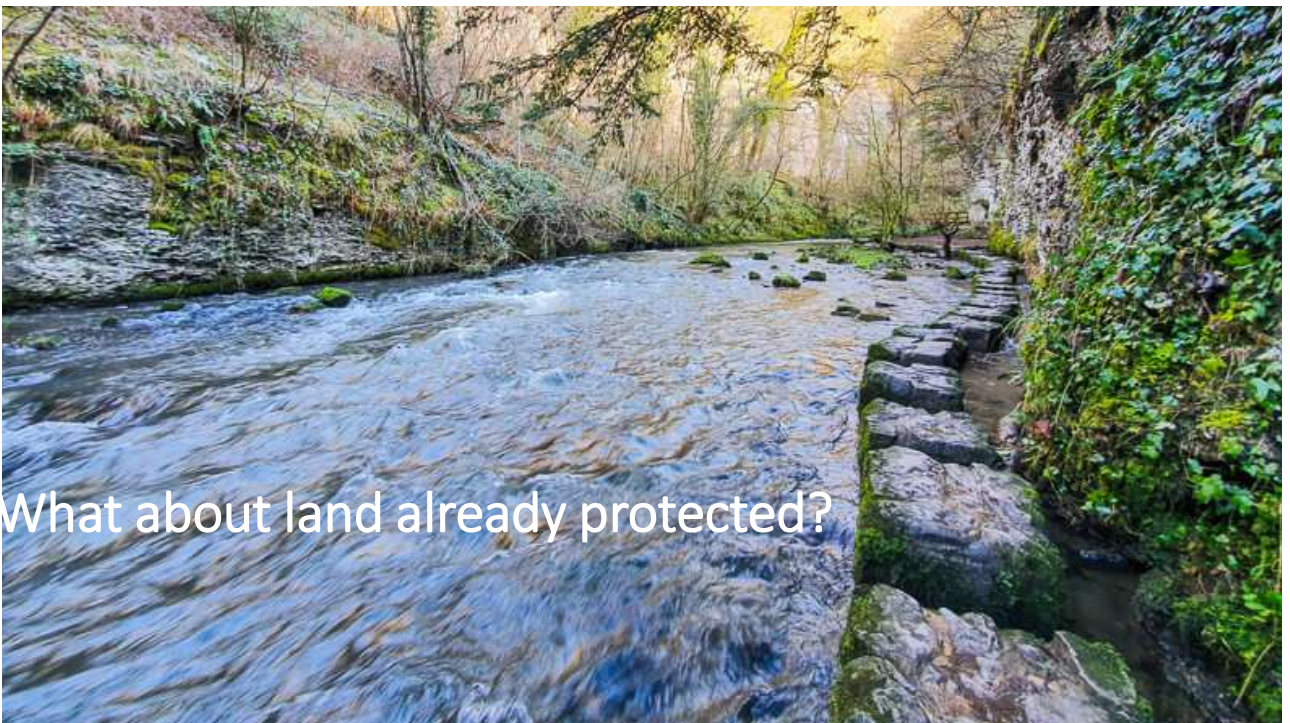

What about land already protected?

Total Sites of Special Scientific Interest (SSSIs) in the Peak District - 50,102 Ha

Leaving 61,552Ha to be improved?

However - many SSSIs in the Peak District are not in a good condition



Quiz time

What two species of butterfly are shown?



Silver washed fritillary



Essex Skipper



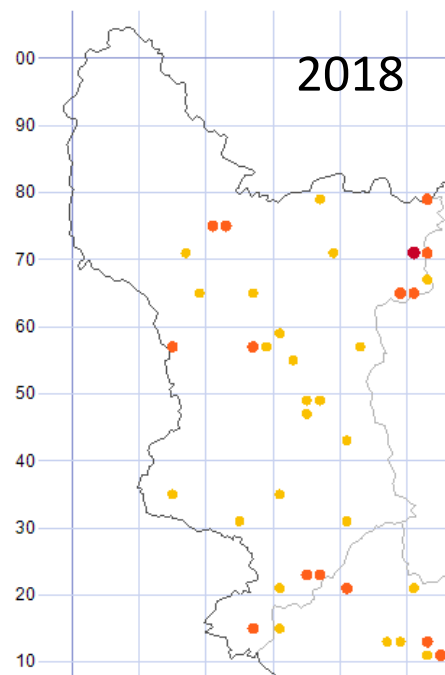
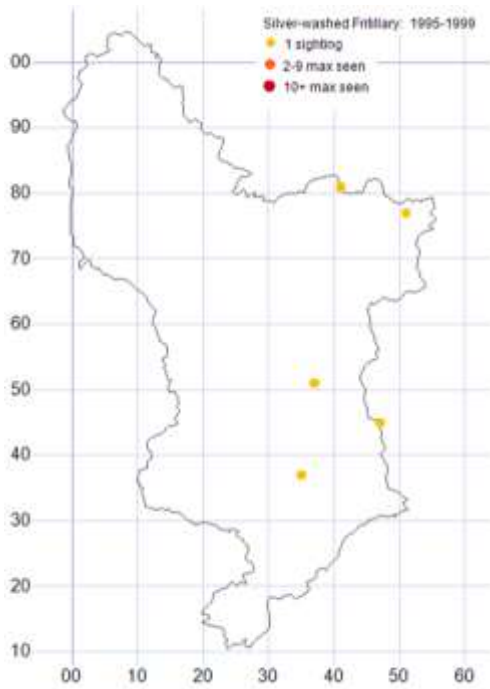
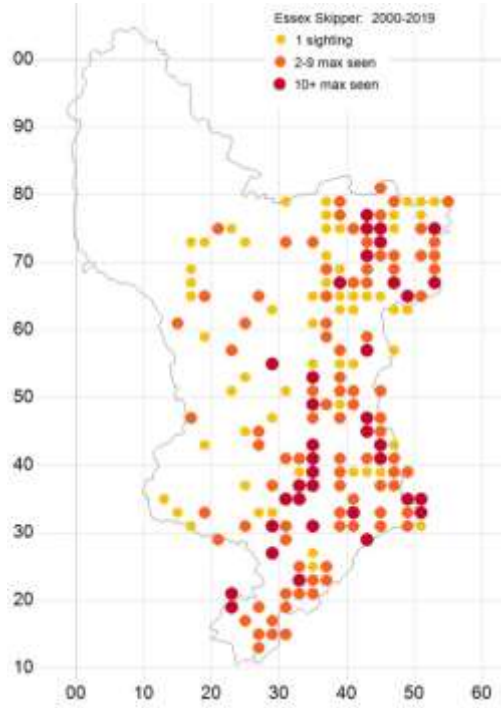

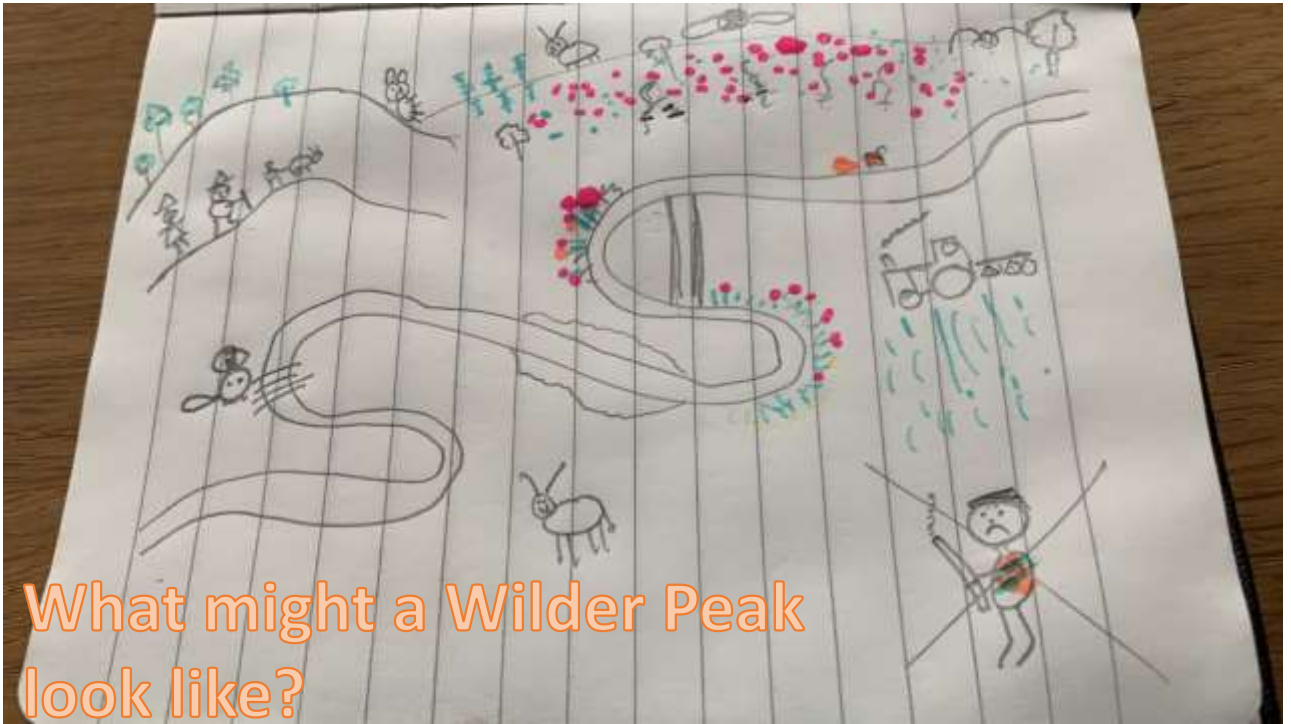

What might a Wilder Peak look like?



NATURE IS REWILDING OUR NEWEST RESERVE ...THORNHILL CARR

What is rewilding and what does it give us?
Wildlife is becoming more common in our gardens, parks and countryside. But our countryside is becoming less wild. Rewilding is about giving nature the space it needs to flourish. It's about letting nature take over the land and making it wilder. This means letting nature take over the land and making it wilder. This means letting nature take over the land and making it wilder.

Why wildlife needs our help
Wildlife is becoming more common in our gardens, parks and countryside. But our countryside is becoming less wild. Rewilding is about giving nature the space it needs to flourish. It's about letting nature take over the land and making it wilder. This means letting nature take over the land and making it wilder.

Join us today and help us to make more of Derbyshire wilder!

PLEASE COMPLETE OUR NATURE RECOVERY NETWORK SURVEY... AND PLEASE ACCEPT THIS INVITATION TO BECOME A MEMBER!

JOIN NOW
RENEWING OUR COUNTRY
A WILD GARDEN GUIDE
MEMBER PRICE £10.00



Derbyshire Wildlife Trust's newest reserve - already rich in wildlife - but could it be wilder?





How ambitious should we be? And could some species act as substitutes for species we can't get back?





Now

What would we like the Peak District to look like in 2050?

And how do we get there?

Exmoor National Park Authority have created this vision of how they would like their national park to look in 2050.



2050



We need to work in partnership with others - with landowners, farmers, local communities, and public bodies .



But we can be ambitious and creative.

What is this?

One of the most important ecosystem engineers in the animal kingdom - and it's coming back to Derbyshire soon!



DWT Beaver reintroduction - Willington Wetlands Reserve

DWT have -

- Secured £190,000 funding
- Obtained licences and permits
- Release planned for spring 2021.

Beavers will bring -

- Nature based solutions
- Socio-economic benefits



<https://www.derbyshirewildlifetrust.org.uk/beaver>

www.derbyshirewildlifetrust.org.uk

Castoreum salubre, insanae Landscapes, imperium potest

You can help too -

- Garden for wildlife
- Join a wildlife group
- Lobby your councillors and MPs to make a difference for wildlife.
- Practical conservation projects.



Thank you!

Any questions??

Dave Savage (email: dsavage@derbyshirewt.co.uk)

Regional Manager (Dark and White Peak)

Derbyshire Wildlife Trust, Sandy Hill, Main Street,
Middleton, Matlock, DE4 4LR

(www.derbyshirewildlifetrust.org.uk)

